

## ADDENDUM NO. 1

First Community Branch Bank  
Brookland, AR

Roark · Perkins · Perry · Yelvington  
Architects  
713 W. 2<sup>nd</sup> Street  
Little Rock, AR 72201  
501-372-0272

Project #1654

February 18, 2020

This addendum forms a part of the Contract Documents and modifies the original Bidding Documents dated January 9, 2019 as noted below. Acknowledge receipt of this Addendum in the space provided on the Bid Form. Failure to do so may subject the Bidder to disqualification.

This addendum consists of 2 pages, 4 new drawings ADD1.1, ADD1.2, ADD1.3, and ADD1.4, and 1 reissued Sheet M1.1.

### I. CHANGES TO PROJECT MANUAL

#### A. Section 08 71 00, Door Hardware:

1. Refer to Hardware Schedule: Change hardware set C715A to door 26, not 27.

### II. CHANGES TO DRAWINGS

#### A. Civil Clarification:

1. Flared end sections are not acceptable at head walls.
2. Downspout connections are 4". Downspout collectors are 8".

#### B. Sheets C1.01, C1.02, C1.03: Refer to attached new Drawings ADD1.1, ADD1.2, and ADD1.3, for revised Hwy. 49 driveway layout.

#### C. Sheet C2.01: Refer to attached new Drawing ADD1.4 for Storm Sewer Line #1 revision.

#### D. Sheets A4.1, A4.4 and A4.5:

1. Refer to Q/A4.4 and T/A4.5: Change the studs in the fire rated wall to be 6" studs, 600S2000-68 @ 16" O.C. These walls extend to the roof deck, as shown.
2. Refer to N/A4.4: The furring and the wall at the vault is to extend to the bottom of the trusses, not to the roof deck.
3. Refer to P/A4.4: These studs are to be 3-5/8", 362S162-97.
4. Refer to A and B/A4.1: Refer to 4/S5.2 for continuous plate on top of W12x26 beam with angle kickers.
5. Change keyed detail reference from V/A4.5 to S/A4.5.

#### E. Sheet A5.1:

1. Change door type D to hollow metal. Omit transom and sidelite (no glass).
2. Door #26 is a single door, not a pair.

F. Sheet M1.1. Entire sheet is replaced due to ductwork revisions. See attached, revised Sheet M1.1.

G. Sheet M3.1:

1. Refer to these schedules: Split System Electric Heat Pumps with Electric Heat, Mini-Split System Ductless Heat Pump and Split System Fan Coil with Electric Heat. This note is added to all three schedules: All Thermostats to be Wifi Compatible with Smart Phones and Personal Computers.

H. Sheet P1.1:

1. Refer to room 113 Staff Lounge. Keyed Note 8, regarding the residential dishwasher connections, is at the wrong location. See architectural floor plan for exact location of the dishwasher.

END OF ADDENDUM

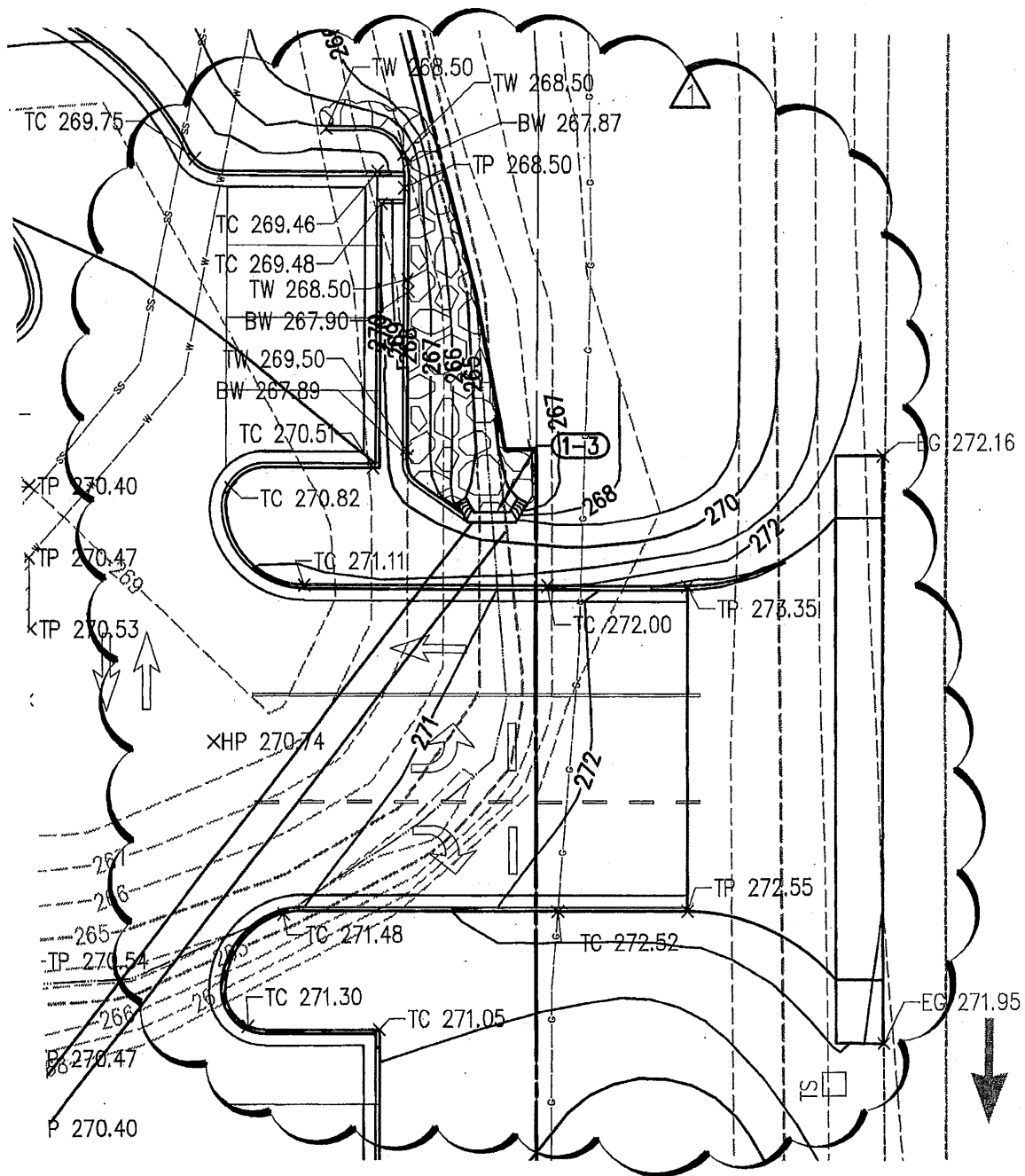

GRAPHIC SCALE IN FEET

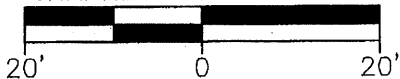

△ REV. DRIVEWAY 02/17/20

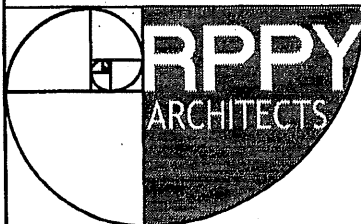

**ROARK · PERKINS · PERRY · YELVINGTON**

ARCHITECTURE • INTERIOR DESIGN  
713 WEST SECOND STREET, LITTLE ROCK, AR. 72201 (501) 372-0272 FAX (501) 372-3645

**First Community Branch**

**Bank**  
Brookland, AR

JOB NUMBER  
**1654**

ADDENDUM

**ADD 3.1**

DRAWING: G:\19806900\_FBCBROOKLAND\INFRASTRUCTURE\CIVIL\DWG\IGRADING PLAN.DWG  
LAYOUT: ADD. 1 2.17.20, LAST SAVED: MF1409, 2/18/2020 9:28:06 AM  
LAST PLOTTED BY: MAGGIE FREY, 2/18/2020 9:28:23 AM ("PLOTTED BY:" VALID ON HARD COPY ONLY)

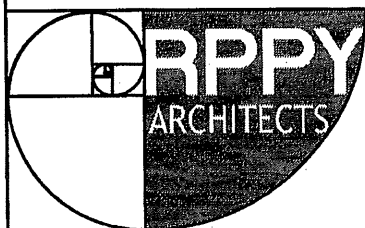
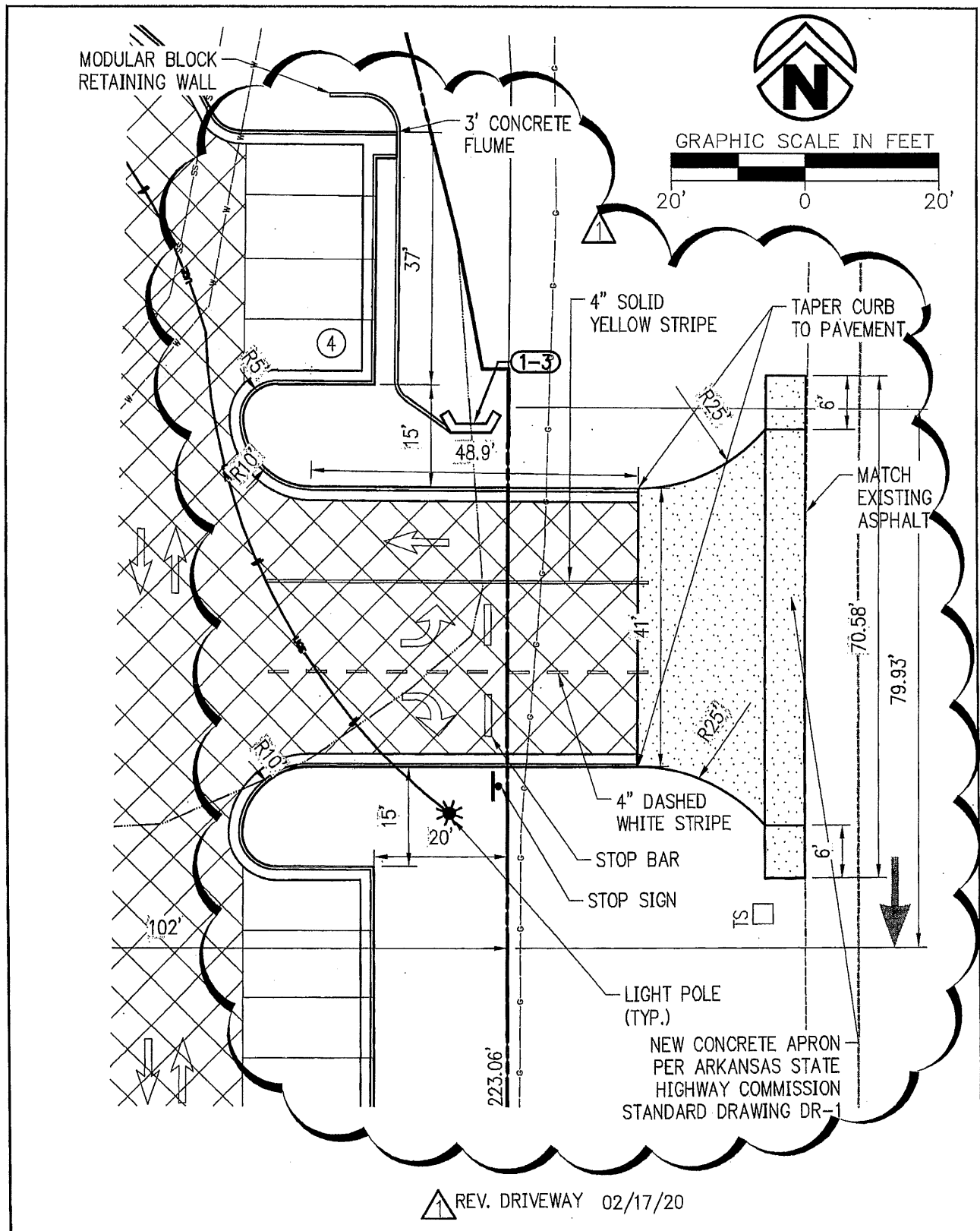

**ROARK · PERKINS · PERRY · YELVINGTON**  
 ARCHITECTURE • INTERIOR DESIGN  
 713 WEST SECOND STREET, LITTLE ROCK, AR. 72201 (501) 372-0272 FAX (501) 372-9645

**First Community Branch**  
**Bank**  
 Brookland, AR

JOB NUMBER  
**1654**

ADDENDUM

**ADD 3.2**

DRAWING: G:\19806900\_FBCBROOKLIN\INFRASTRUCTURE\CIVIL\DWG\SITE PLAN.DWG  
 LAYOUT: ADD. 1 2.17.20, LAST SAVED: MF1409, 2/18/2020 9:25:15 AM  
 LAST PLOTTED BY: MAGGIE FREY, 2/18/2020 9:26:32 AM ("PLOTTED BY:" VALID ON HARD COPY ONLY)

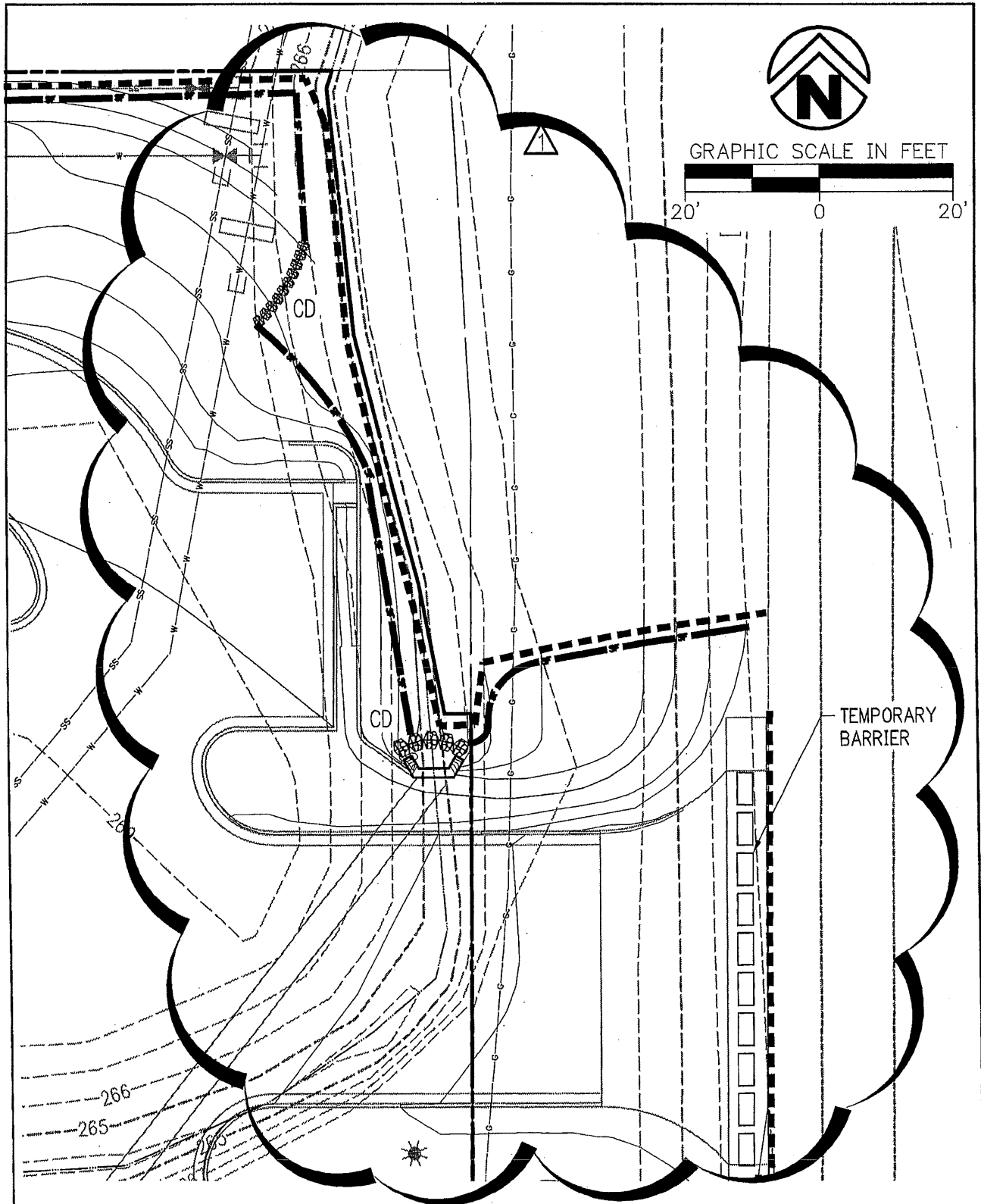

REV. DRIVEWAY 02/17/20

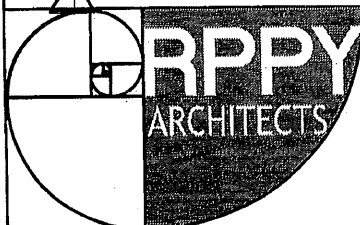

**ROARK · PERKINS · PERRY · YELVINGTON**  
 ARCHITECTURE • INTERIOR DESIGN  
 713 WEST SECOND STREET, LITTLE ROCK, AR. 72201 (501) 372-0272 FAX (501) 372-3645

JOB NUMBER  
**1654**

**First Community Branch**  
**Bank**  
 Brookland, AR

ADDENDUM

**ADD 3.3**

DRAWING: G:\19806900\_FBCBROOKLN\INFRASTRUCTURE\CIVIL\DWG\EROSION CONTROL PLAN.DWG  
 LAYOUT: ADD. 1 2.17.20, LAST SAVED: MF1409, 2/18/2020 9:30:00 AM  
 LAST PLOTTED BY: MAGGIE FREY, 2/18/2020 9:31:07 AM ("PLOTTED BY:" VALID ON HARD COPY ONLY)

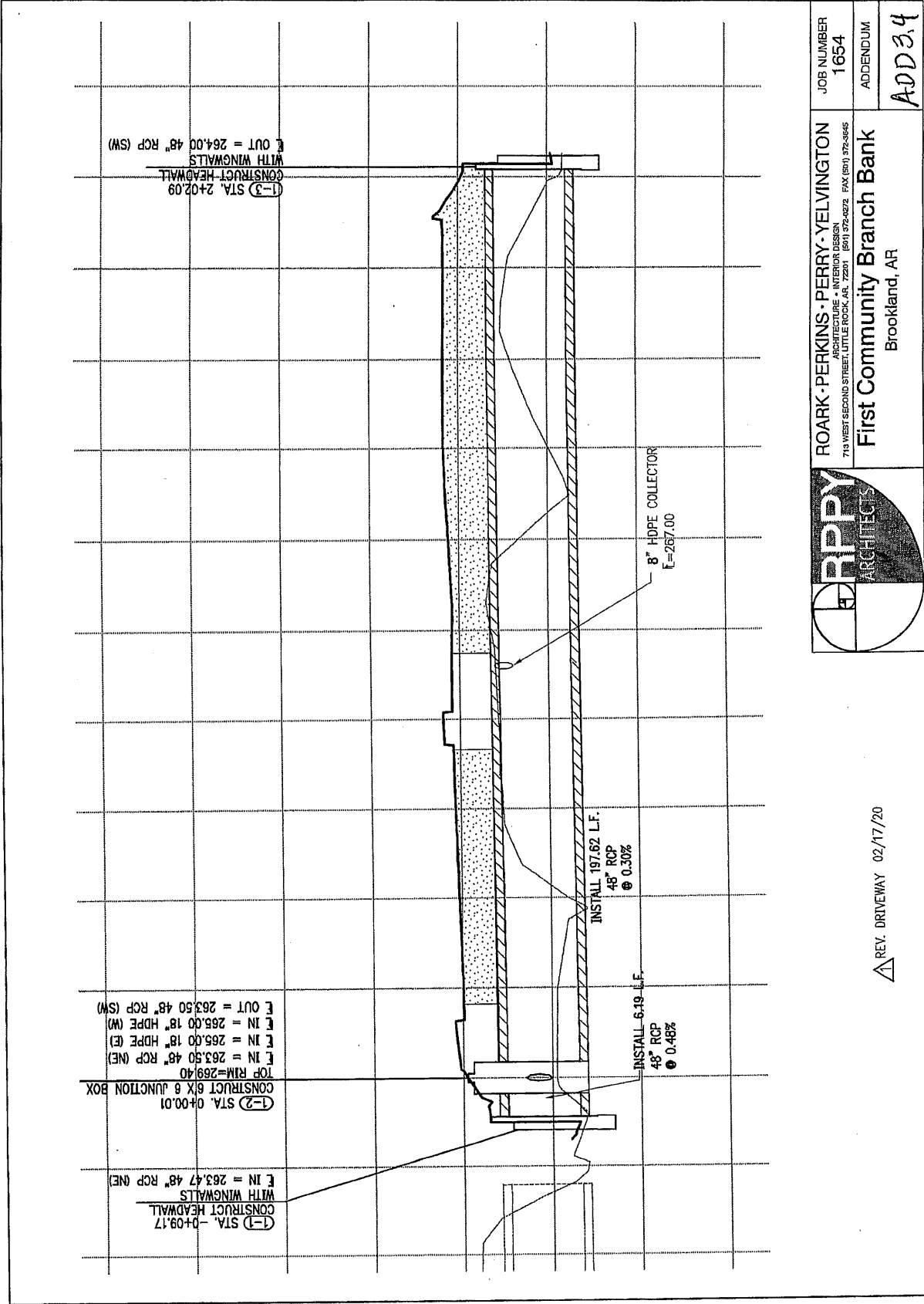

DRAWING: CA 19826900, ECHIBROOK INFRASTRUCTURE CIVIL DWG, LISTE-PF.DWG  
 LAYOUT: ADD. 1 217.20, LAST SAVED: MF 4-09 2/18/2020 9:40:33 AM  
 LAST PLOTTED BY: MAGGIE REY, 2/18/2020 9:40:33 AM, IT: COTED BY: VALID ON HARD COPY ONLY

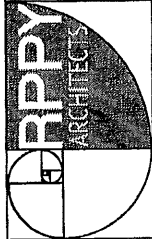

ROARK PERKINS PERRY YELVINGTON  
 ARCHITECTURE INTERIOR DESIGN  
 713 WEST SECOND STREET, LITTLE ROCK, AR, 72201 (501) 372-6622 FAX (501) 372-6645  
**First Community Branch Bank**  
 Brookland, AR

JOB NUMBER  
**1654**  
 ADDENDUM  
**ADD 3.4**

REV. DRIVEWAY 02/17/20