

BIDDING ADDENDA
Section 00 91 13 / Rev: August 2021

Date: 11/26/24 Village Creek State Park,
Sport Court Complex Improvements

Addendum Number: 1

Project Number: 9002504

Agency Name: Arkansas Dept. of Parks, Heritage, and Tourism

The proposed contract documents for this work are modified as follows:

1 INVITATION TO BID

Bid date is December 4, 2024 at 2pm

2 SPECIFICATIONS

**Addition of specification 32 18 24 Tennis Court Surfacing
and 01 25 13 Substitution Procedures**

3 DRAWINGS

L 40-2, Remove the drinking water fountain and waterline from the project.

SECTION 32 18 24

TENNIS COURT SURFACING

PART 1 – GENERAL

1.01 SCOPE

- A. Surfacing tasks for tennis courts include furnishing all labor, materials and equipment necessary. Work will be accomplished in a thorough and workmanlike manner. The specified products will be prepared and applied strictly in accordance with the manufacturer's recommendations.

1.02 RELATED WORK SPECIFIED ELSEWHERE

- A. Section 32 13 50 Post-Tensioned Concrete

1.03 SUBMITTALS

- A. The Contractor will prepare five (5) complete submittal packages of current specifications and product literature from the manufacturer.
- B. The submittal package must be approved before work may begin. The Contractor must allow one (1) week from the time the submittals are received by the Landscape Architect until the review is completed and returned to the Contractor.

1.04 LIMITS OF WORK

- A. Unless otherwise indicated on the plans, the extent of tennis court surfacing shall cover the entire court surface which is to the outside edge of the post tensioned concrete slab.

1.05 PROTECTION OF EXISTING IMPROVEMENTS

- A. The Contractor will be responsible for protection of existing improvements such as fencing, net posts, paving, turf areas, light poles, etc. from damage and coloration from surfacing materials. Any damage to existing improvements will be cleaned, repaired and restored to the original condition or better at the Contractors expense.

1.06 STANDARDS

- A. Tennis court color finishes and court preparation materials shall be applied by methods which are in compliance with standards for tennis court construction as described by the American Sports Builders Association and the United States Tennis Association. If there is a conflict

between these specifications and those of the ASBA and USTA these specifications will apply. Any work that does not conform to these specifications shall be removed and corrected at the Contractors expense without any extension in time.

1.07 GUARANTEE

- A. The Contractor shall guarantee their work to be sound for one (1) year from the date of final acceptance. This guarantee for court preparation and surfacing materials shall cover the following:
1. Materials have been manufactured and applied in accordance with these and the manufacturer's specifications.
 2. Materials will hold fast and adhere to the concrete paving.
 3. Materials have been applied at the specified quantity and thickness.
 4. Materials will perform as specified by the manufacturer.

1.08 QUALIFICATIONS

- A. The tennis court surfacing Contractor shall submit a list of completed tennis court surfacing projects complete in the last five (5) years with the client, location, completion date and telephone number of the Client. Tennis court surfacing Contractor must have completed at least ten (10) similar projects in the last five (5) years.

PART 2- PRODUCTS

2.01 APPROVED EQUAL SUBSTITUTIONS

- A. If a Bidder wishes to submit an item for consideration as an "approved equal" each item must meet all the requirements of the "Approved Equal Substitutions" as described in Section 01 25 13 SUBSTITUTION PROCEDURES of these specifications.

2.02 COURT PREPARATION MATERIALS

- A. Acid for Cleaning and Etching Concrete Court Surface: An acid pre-treatment shall be applied to all new concrete paving for the purpose of preparing the concrete surface which is to receive the court surfacing materials.
1. Use "Concrete Preparer" consisting of phosphoric acid and zinc chloride, manufactured by California Products Corporation, or approved equal. "Concrete Preparer" is self-neutralizing, requires no after-wash and forms a water insoluble reaction with the surface of the concrete. This surface reaction creates a barrier to reduce the osmotic effect of water vapor and moisture which can create blisters and will adversely impact the bond between the concrete surface and the surfacing materials.

- B. Primer for Concrete Court Surfaces: Primer shall be a clear two-packaged water based epoxy primer that penetrates concrete with an alkali resistant polymeric coating that tightly adheres to the irregularities of the concrete surface.
1. Use "Ti-Coat" manufactured by California Products Corporation, or approved equal.
- C. Deep Patching Material: Patching material for deep patches shall be a high strength acrylic latex bonding liquid that is mixed with silica sand and Portland cement. Deep patching material shall only be used to fill depressions that are deeper than one quarter (1/4") inch in depth.
1. Use "Court Patch Binder" manufactured by California Products Corporation, or approved equal.
- D. Slurry for Base Filler Coat and Shallow Patching: The base filler coat and shallow patching material shall be an asbestos free, acrylic latex binder suitable for mixing with water and graded silica sand to form a slurry. The thickness of each base filler coat will not exceed one quarter (1/4") inch in thickness. The slurry coat will be applied for the following purposes:
- To patch birdbaths and shallow depressions less than one quarter (1/4") inch deep.
 - To reduce porosity, to fill hairline cracks and to fill other minor irregularities in the tennis court surface.
 - To level and "true-up" the paved surface prior to application of the color court surfacing.
 - To provide the entire surface of the court pavement with a uniform texture.
1. Use black pigmented "Acrylic Resurfacer" manufactured by California Products Corporation, or approved equal.
 2. Recommended Resurfacer Mix Rate;
 - Acrylic Resurfacer..... 55 gallons
 - Water (potable)..... 20-40 gallons
 - Sand (60 to 80 mesh) 600-900 pounds
 - Liquid Yield..... 112-138 gallons

2.03 COLOR FINISH MATERIALS

- A. Color finish materials shall be asbestos free, highly pigmented, texturized, acrylic latex coatings containing only inert mineral pigment colorants which are suitable for exterior use. The color coating shall contain sufficient filler to give a uniform appearance and texture. The material is to be fade resistant, tack free and subject to no deterioration due to temperature, moisture or ultraviolet exposure. Nothing in the coatings shall be detrimental to the existing or newly

applied surfacing or court preparation materials. The material for the color finish shall contain no vinyl, butadiene styrene or alkyds and shall be thinned with water only per the manufacturer's recommendations. The color finish system shall contain no asphalt, tar emulsions or non-acrylic resins.

1. Use "Job-Mixed Fortified Plexipave" manufactured by California Products Corporation, or approved equal.
2. The color selection shall be as noted on the plans. Contractor to provide color samples for approval.

2.04 STRIPING PAINT

- A. Striping paint shall be a fast drying, non-glare, high-hiding and highly reflective acrylic latex paint. Oil-based or solvent-type paints are not permissible. Striping paint shall be pre-mixed with fine silica fillers per the manufacturer's recommendations to provide a texturized line paint which has the same texture as the remainder of the court surfacing.
- B. The line paint shall be a one hundred (100%) percent acrylic emulsion type paint containing no alkyds, butadiene styrene or vinyl and shall be thinned with water only. The paint shall be suitable for application with a brush, roller or spray. All materials used to manufacture the paint shall be good commercial quality entirely suitable for the purpose intended under normal conditions of use. The opaque portion of the white paint shall be rutile titanium dioxide and shall consist of one hundred (100%) percent acrylic polymers dispersed in water together with the minimum amounts of the necessary additives, such as, pigment dispersants, anti-foaming agents and preservatives. No driers will be added. The paint shall meet a minimum requirement of total solids (percent by weight of paint) of fifty-one and a half (50.5%) percent and a maximum pigment content (percent by weight of paint) of thirty-four (34%) percent. The white paint shall contain no less than three (3) pounds per gallon of treated rutile titanium dioxide. A minimum fineness of grind of four (4) and minimum viscosity of seventy (70) Krebs and a maximum of eighty-five (85) Krebs is required. The paint shall be easily applied and shall have good flowing, leveling and spreading characteristics.
 1. Use "High-Hide Plexicolor Line Paint" manufactured by California Products Corporation, or approved equal.

2.05 MATERIAL LABELS AND CONTAINERS

- A. Court surfacing and patching materials shall be delivered to the site in sealed containers, properly marked with the manufacturer's label and stenciled with the proper batch code. Products packaged or labeled in any other manner will not be accepted.

PART 3 – EXECUTION

3.01 SURFACE PLANE AND CONDITION OF NEW COURTS

- A. The new tennis court pavement designated to receive court surfacing shall have been placed to the slope, pitch and grade shown on the plans with no variations greater than one eighth (1/8") inch when measured along a ten (10') foot straight edge in any direction. Concrete surfaces shall have a consistent light to medium broom finish. Court surfaces that do not meet these requirements must be corrected before surfacing is applied.
 - 1. The tennis court surfacing Contractor must inspect and approve in writing that the concrete base is true in plane and slope and is acceptable and ready for application of court surfacing materials. Any deficiencies noted during the inspection shall be presented to the General Contractor in writing for correction prior to beginning work.

3.02 ADVERSE CONDITIONS

- A. Court preparation materials and color finish materials cannot be applied when adverse conditions exist. Adverse conditions include excessive air pollutants, blowing sand and other materials, excessive humidity, present or imminent precipitation, high or low temperatures, adverse court conditions and other conditions and limitations specified by the product manufacturer that will be detrimental to the products performance and the specified results. In general, no surfacing work will be done when the air temperature is currently or expected to fall below fifty (50) degrees during the drying/curing period. No surfacing work will be done when the court surface temperature is more than one hundred and forty (140) degrees.
- B. All materials and containers stored on site must be protected from extreme heat and cold which will adversely affect the products performance.

3.03 COURT PREPERATION

- A. Prior to the start of tennis court surfacing the newly placed concrete paving must cure for a minimum of twenty-eight (28) days.
- B. All ridges or rough spots in the concrete paving must be removed by grinding or scraping prior to the application of court surfacing material. The grinding or scraping must not create a different texture from the surrounding concrete and the edges of the repaired area must be "feathered in" to avoid a patched appearance.

3.04 SWEEP AND CLEAN COURTS

- A. The court surface must be swept to remove gravel, dust, dead vegetation, chipped and spalled concrete, foreign matter and any other debris prior to washing the courts. Power blowers may be used for this task.

- B. After sweeping the courts must be thoroughly washed using scrub brushes, detergent and a high-pressure stream of water to remove dirt, mud, grease, airborne pollutants and all loose material.

3.05 ACID TREATMENT

- A. The entire surface of the tennis courts should be treated with acid to prepare the courts for surfacing. Dilute one (1) gallon of "Concrete Preparer" with four (4) gallons of clean water and then apply to the court surface at a rate of one (1) gallon of undiluted "Concrete Preparer" per seven hundred (700) to nine hundred (900) square feet of court surface. Apply the acid treatment by pouring the liquid on the court surface and spreading with a stiff broom. Allow the courts to air dry before applying court surfacing material. Any puddles should be dispersed by broom or squeegee after the chemical reaction has stopped.

3.06 PATCHING BIRDBATHS AND MINOR SURFACE IRREGULARITIES

- A. To determine the location of birdbaths the courts should be flooded with water in the presence of the Owner and Landscape Architect. After the courts are allowed to dry puddles that are deeper than the thickness of a nickel should be marked with chalk or keel. These depressions should be filled with "Court Patch Binder".
- B. Prior to applying the patching material the depression shall be treated with a tack coat of one (1) part "Court Patch Binder" to two (2) parts water and allowed to dry.
- C. The patching material shall be mixed at the following rate:
 - 3 gallons of "Court Patch Binder"
 - 100 pounds of 60-80 mesh dry silica sand
 - 1 to 2 gallons of Type I Portland Cement (20 pounds minimum)
- D. After patching the surface of the patch shall not vary more than one eighth (1/8") inch in any direction when measured with a ten (10') foot straight edge.

3.07 PRIMING

- A. Apply a thin coat of the "Ti-Coat" primer to the acid treated concrete surface. Allow this material to dry at least two (2) hours before the next surfacing step.

3.08 BASE FILLER COATS

- A. Base filler coats cannot be applied until all court preparation steps have been completed and approved by the Owner and/or Landscape Architect.
- B. "Acrylic Resurfacer" base filler shall be mixed per the manufacturer's recommendations. Mix shall be tweaked within the recommended limits to achieve the desired court finish and

texture. The final mix should be a creamy slurry of easy spreading consistency but thick enough to prevent sand drop out. Base filler shall be mixed to the rates noted in Item 2.02. Ingredients shall be thoroughly mixed in a mortar box or mortar mixer.

- C. Within one (1) to three (3) hours of the prime coat application the entire surface of the courts must be uniformly covered with the base filler coat using a seventy (70) durometer flexible rubber squeegee, twenty-four (24") to thirty six (36") inches in width. The final coat must be uniform in texture, completely hiding all pavement irregularities, and will be smooth and free of shrinkage or mud cracks. Each coat shall be allowed to thoroughly dry before the application of the subsequent coat. Remove all ridges and rough spots prior to the application of the next base coat or color finish coat.
- D. The application rate for the base filler coats shall be one (1) gallon of unmixed "Acrylic Resurfacer" per one hundred thirty-five (135) to one hundred eighty (180) square feet of court surface. The thickness of each coat shall not exceed one quarter (1/4") inch.
- E. A minimum of two (2) base filler coats are required. More finish coats will be required if the initial coats do not produce the desired results.

3.09 COLOR FINISH COATS

- A. The finish color coats of "Fortified Plexipave" shall be a mixture of Plexipave Color Base, Plexichrome and water in the following proportions:
 - Plexipave Color Base 30 gallons
 - Plexichrome 20 gallons
 - Water 20 gallons

Within limits approved by the manufacturer, the mix may be adjusted on the job depending on surface porosity and the ambient temperature at the time of application.

- B. Apply two (2) coats of the "Fortified Plexipave" with a twenty-four (24") to thirty-six (36") inch wide, fifty (50) Durometer flexible rubber squeegee. The application rate for each coat shall be one (1) gallon of mix per one hundred thirty-five (135) to one hundred eighty (180) square feet of court surface, depending on the surface porosity. The final coat shall be placed perpendicular to the courts length and shall be smooth, uniform, without puddles or thick spots that may cause "mud cracking". Prior to installing the final coat make a careful inspection of the surface and remove any ridges, loose or foreign particles and bumps.
- C. The final coat shall be a "Plexichrome" finish coat with a mix rate of one (1) part water to one (1) part "Plexichrome". Finish coat shall be applied with a wide hair-type push broom. The final coat shall be applied perpendicular to the court and shall be smooth and uniform. The application rate shall be one (1) gallon of undiluted "Plexichrome" per one hundred eighty (180) to two hundred twenty-five (225) square feet of court surface.

- D. The final result of the color finish coats shall be uniform color throughout when viewed at mid-day from the edge of the court at a distance of twenty-five (25') feet.

3.10 PAINT COURT STRIPING

- A. Two (2") inch wide textured white paint lines conforming to USTA specifications shall be laid out according to the court markings shown on the plans. Line paint shall be applied no sooner than four (4) hours after the finish cost is applied. Line paint shall be applied with a brush, roller or spray. Lines shall be clean with sharp edges free of any fogging, splatter or over spray.

3.11 CLEAN UP

- A. The Contractor is responsible for removing and disposing of all containers, surplus materials rubbish, trash, debris and any foreign materials resulting from surfacing work. All surfacing material spilled on lawn areas or adjacent paved areas must be removed and the lawn or paving restored to its original or better condition. In general, the site shall be left in a clean and orderly condition acceptable to the Owner.

END OF SECTION

SECTION 01 63 00

SUBSTITUTIONS AND PRODUCT OPTIONS

PART 1 – GENERAL

1.01 REQUIREMENT INCLUDED

- A. Furnish and install Products specified, under conditions for options and substitutions stated in this Section.

1.02 PRODUCTS LIST

- A. Within thirty (30) days after award of Contract, submit to the Landscape Architect five (5) copies of the complete list of major Products which are proposed for installation.
- B. Tabulate Products by Specification section, number and title.
- C. For Products specified only by reference standards, list each such Product:
 - 1. Name and address of the manufacturer.
 - 2. Trade name.
 - 3. Model or catalogue designation.
 - 4. Manufacturer's data:
 - a. Reference standards.
 - b. Performance test data.

1.03 CONTRACTOR'S OPTIONS

- A. For Products specified only by reference standards, select Products meeting that standard, by any manufacturer.
- B. For Products specified by naming several Products or manufacturers, select any one of the Products and manufacturers named which complies with the Specifications.
- C. For Products specified by naming only on Product and manufacturer, there is no option and no substitution will be allowed (unless substitution is approved prior to the Bid Opening).

1.04 SUBSTITUTION PROCEDURE

- A. Prior to the Bid Date: Landscape Architect will consider substitutions as specified in the Instructions to Bidders.

- B. After the Bid Date: Landscape Architect will consider formal written requests from the Contractor for substitution of products in place of those specified only when submitted in accordance with the requirements of this Section. Substitution requests must be presented in writing no later than thirty (30) days after Notice to Proceed. One or more of the following conditions must be documented:
1. The Substitution must be required for compliance with final interpretation of code requirements or insurance requirements.
 2. The substitution must be due to the unavailability of the specified Products, through no fault of the Contractor. Long delivery period will not qualify as unavailability.
 3. The substitution may be requested when subsequent information discloses the inability of the specified Products to perform properly or to fit in the designated space.
 4. The substitution may be due to the manufacturer's or fabricator's refusal to certify or guarantee performance of the specified Product as required.
 5. The substitution may be requested when it is clearly seen, in the judgment of the Landscape Architect that a substitution would be substantially to the Owner's best interest in terms of cost, time or other considerations.
- C. Submit a separate request for each substitution on a copy of the requested form attached to this Specification section. Support each request with the following:
1. Complete data substantiating compliance of the proposed substitution with requirements stated in the Contract Documents including:
 - a. Product identification, including manufacturer's name and address.
 - b. Manufacturer's literature.
 - c. Samples, as applicable.
 - d. Name and address of similar projects on which the Product has been used, and the date of installation.
 2. Itemized comparison of the proposed substitution with the Product specified; list significant variations.
 3. Date relating to changes in construction schedule.
 4. Any effect of substitution on separate contracts.
 5. List of changes required in other Work or Products.
 6. Accurate cost data comparing proposed substitution with the Product specified.
 - a. Amount of any net change in the Contract Sum.
 7. Designation of required license fees or royalties.
 8. Designation of availability of maintenance services, sources or replacement materials.
- D. Substitutions will not be considered for acceptance when the following occur:
1. Substitution's are indicated or implied on Shop Drawings or Product data submittals without a formal request from the Contractor.
 2. Substitution's are requested directly by a sub-contractor or supplier.
 3. Acceptance will require substantial revisions of the Contract Documents.
- E. Substitute Products shall not be ordered or installed without written acceptance from the Landscape Architect or Owner.
- F. Landscape Architect and Owner will determine acceptability of the proposed substitution.

1.05 CONTRACTOR'S REPRESENTATION

- A. In making a formal request for a substitution the Contractor represents the following:
 - 1. They have investigated the proposed Product and have determined that is equal to or superior in all respects to the specified Product.
 - 2. They will provide same warranties or bonds for the substitution as for the specified Product.
 - 3. They will coordinate installation of the accepted substitution into the Work, and will make such changes as may be required for the Work to complete in all respects.
 - 4. They wave claims for additional costs caused by the substitution which may subsequently become apparent.
 - 5. Cost data is complete and includes related costs under this Contract, but not the following:
 - a. Cost under separate contracts.
 - b. Landscape Architect costs for redesign or revisions of the Contract Documents.
 - 6. They will reimburse the Owner separately for fees paid to the Landscape Architect for redesign, revisions of the Contract Documents and review of each substitution request.

1.07 LANDSCAPE ARCHITECT'S DUTIES

- A. Review Contractor's request for substitutions with reasonable promptness.
- B. Notify Contractor, in writing, of decision to accept or reject the requested substitution.

END OF SECTION

FILE NAME: A:\43000s\43617\011\ACADD\Sheets\PLAN-SITE-43617.011.dwg DATE: November 26, 2024, TIME: 3:00 PM, USER: an5220 AVO: 43617.011

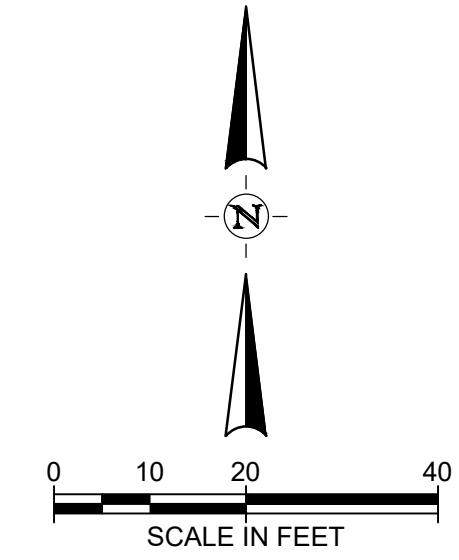
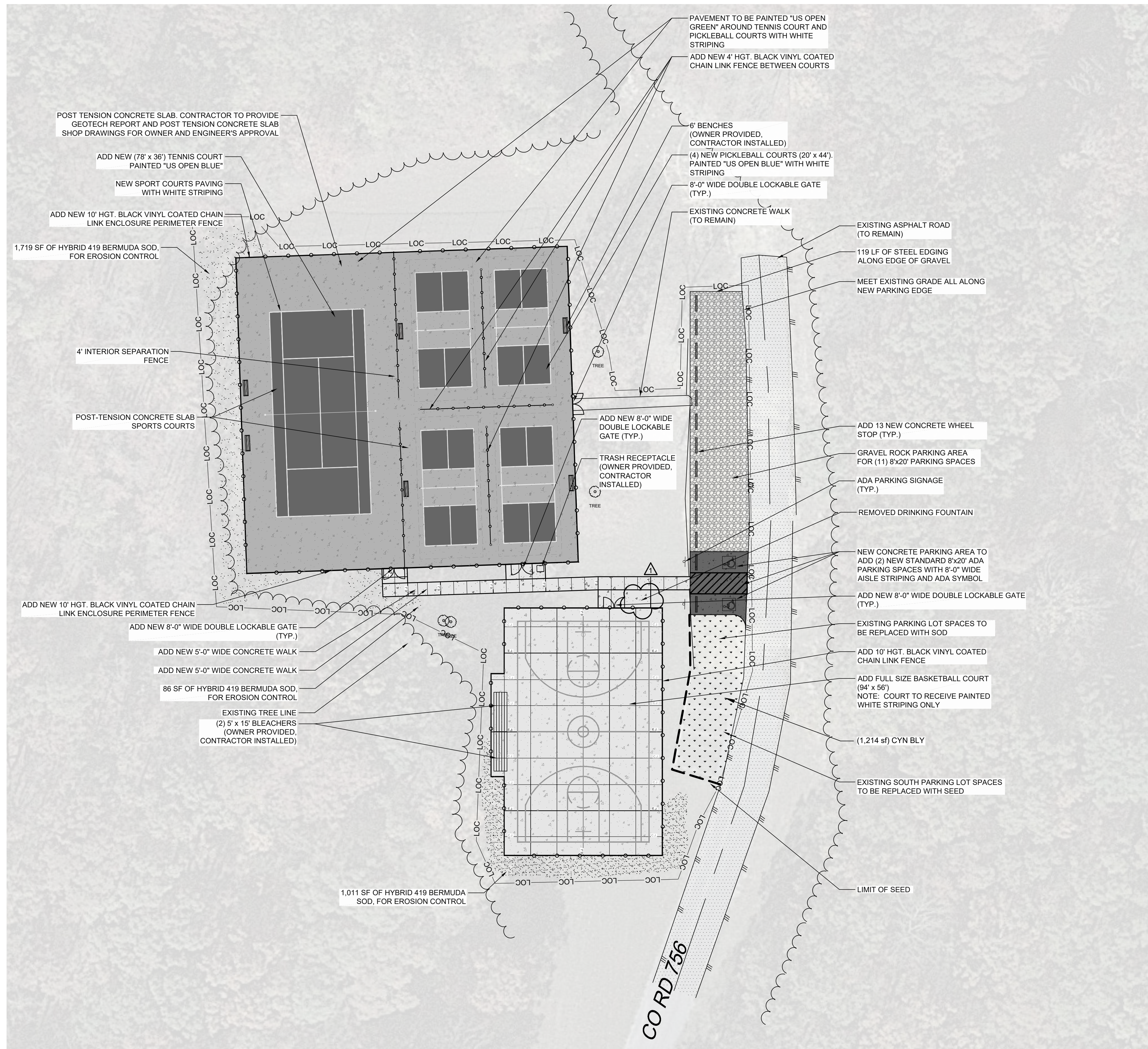

LEGEND

- POST TENSION CONCRETE TO BE PAINTED "US OPEN GREEN" OR APPROVED EQUAL
- POST TENSION CONCRETE TO BE PAINTED "US OPEN BLUE" OR APPROVED EQUAL
- NEW CONCRETE WALK (5" THICK)
- NEW CONCRETE ADA PARKING LOT PAVING (8" THICK)
- NEW GRAVEL ROCK PARKING AREA 6" CLASS 7 BASE COURSE COMPACTED TO 98% MODIFIED PROCTOR
- STEEL EDGING
- NEW CHAIN-LINK FENCE
- EXISTING TREE (TO REMAIN)
- LIMITS OF CONSTRUCTION
- LIMITS OF SEED

PLANT SCHEDULE

SYMBOL	QTY	COMMON / BOTANICAL NAME	CONT	SIZE
	1,214 sf	Hybrid 419 Bermuda Seed / Cynodon transvaalensis - 98% pure seed; seed at a minimum rate of 30 lbs. of seed per acre and as required for germination. Note: Hydromulching shall be required; do not substitute other methods of seeding. Seeding shall be done between May 15 and August 1.	Hydromulch	30 lbs./acre
	2,996 sf	Hybrid 419 Bermuda Sod / Cynodon transvaalensis - Solid Sod, free of weeds and other grasses; turf free of insects and debris.	Solid Sod	

NOTES

- ALL TREES TO REMAIN NEED TO BE PROTECTED DURING DEMOLITION.
- ANY TREE OR BRUSH REMOVAL WILL BE DETERMINED IN THE FIELD DURING THE PRECONSTRUCTION MEETING PER ASP APPROVAL.
- ANY TREES AND BRUSH DETERMINED TO BE REMOVED ARE TO BE REMOVED FROM SITE.
- THE PARK HAS THE FIRST RIGHT OF REFUSAL FOR ALL THE ITEMS BEING REMOVED (BLEACHERS, LIGHT POLE, TRASH CONTAINER, ETC.).
- ALL DISTURBED AREAS WILL BE RESEEDED WITH BERMUDA GRASS SEED.
- THE OWNER WILL PROVIDE THE 6 BENCHES, 1 WATER FOUNTAIN, AND 1 TRASH CAN FOR THE CONTRACTOR TO INSTALL.
- ALL COURTS AREAS TO BE PAINTED WITH LAYKOLD "US OPEN BLUE" AND "US OPEN GREEN" OR APPROVED EQUAL WHERE DESIGNATED ON PLAN.
- POST TENSION CONCRETE SLAB. CONTRACTOR TO PROVIDE GEOTECH REPORT AND POST TENSION CONCRETE SLAB SHOP DRAWINGS FOR OWNER AND ENGINEER'S APPROVAL.

VILLAGE CREEK
STATE PARK
SPORTS COURT COMPLEX
IMPROVEMENTS
WYNNE, ARKANSAS



REVISION NO.	DATE	DESCRIPTION
1	11/26/2024	WATER FOUNTAIN REMOVED



THE SEAL ORIGINALLY APPEARING ON THIS DOCUMENT WAS AUTHORIZED BY:
BRIAN VAZQUEZ 712007
NAME LA LICENSE NO.
11/26/2024
DATE
THE RECORD COPY OF THIS DRAWING IS ON FILE AT THE OFFICES OF:
HALFF ASSOCIATES, INC.
HALFF AR
FIRM OR BUSINESS NO. STATE

PROJECT NO.: 43617.011
ISSUED: 10.04.2024
DRAWN BY: RJC
CHECKED BY: BAV / SBH
SCALE: 1" = 20'
SHEET TITLE
LAKE AUSTELL COURT AREA
SITE PLAN