

ADDENDUM NUMBER ONE

April 11, 2025

Brookland Sportsplex Phase 2

Brookland, Arkansas

The following additions, deletions and/or revisions shall be made part of the Plans dated March 31, 2025 of the referenced project. This addendum shall have precedence over the plans and specifications on all items listed and described herein, however, it shall not change the intent and requirements of the plans and specifications for any item not specifically mentioned.

ITEM NO. 1

REFERENCE DRAWINGS: Layout Plan, Sheet 2

An updated Layout Plan is attached here, with a red line added to illustrate the extent of the work included in this phase (no revision date).

ITEM NO. 2

RESPONSES TO QUESTIONS RECEIVED:

Question 1. Is there any dirt work ?? Fill or Cut ??

Answer: The bulk of earthwork, drain pipe, water and sewer lines were installed with the prior construction phase. The contractor is to base his bid on the site being to grades shown on the plans and that any required grading will be for bringing the sidewalks and fields to grade.

Question 2. Also, Drawing #4 shows only work needs to be performed in Field #2 but Drawings #5 shows on both field 1 and 2. Please clarify this .

Answer: The extent of the work is illustrated on Sheet 4. Additional information may appear on other sheets in the plan set, but the scope of work shown on Drawing 4 is the extent of the work in this phase. The northeast field (Ball Field 2) is the only one in this bid. It includes lighting, irrigation, backstops, fencing dugouts, etc. For clarity, and updated copy of Drawing 2, Site Layout is included, illustrating the limit of work.

Question 3. What area does need Asphalt ?? Both field 1 and 2 needs asphalt parking and do we need to make asphalt drive for North east entrance ??

Answer: As noted in the answer for Question 2, the extent of asphalt pavement is shown on Drawing 4, which includes both entry drives at Brookland School Road West and the parking areas between them, east and north of Ball Field 2.

Question 4. Do we need to supply sports light ?? A3,A4,B3,B4,C3 and C4 and So on.

Answer: As noted in the answer for Question 2, the extent of lighting is shown on Drawing 4, which includes all lights for Ball Field 2.

Question 5. Is there going any Lintels?

Answer: Over every opening in a wall.

Question 6. Doesn't call out a Particular Panel Profile for the roofs. Please provide the profile for Roof panel. Suggestion:- 16", 24 GAUGE, SNAP-LOK PANEL

Answer: 16" wide, 24 gauge, Snap-Lok panel will work.

Question 7. Sub reviewed the irrigation plan and wanted to note a few things. Drawings indicate main line running under the field of play. This is make maintenance issue, as breaks and leaks will occur over time and these will be in the field of play per drawings. This will shut down the field and cause scheduling problems. Drawings indicate control valves are inside the field of play. In addition to the problems just presented there is a safety component to valve boxes being on the field.

Answer: As noted in Irrigation System Note 13 in Detail 1 on Drawing 15, the irrigation system is diagrammatic, to provide clarity. The irrigation main lines and remote control valves should be located outside the field of play, in the general proximity of the locations shown on the plan.

Question 8. Please provide Specs for A3,A4,C3 and C4 spotlights.

Answer: A3-A4: Musco / (2)TLC-LED-1200, (1)TLC-LED-900, (1)TLC-BT-575
C3-C4: Musco / (4)TLC-LED-1500, (2)TLC-BT-575

Question 9. What is the size for the electrical primary conduits? There are two sets of primary and some pull boxes shown.

Answer: (2)4"C per primary set. One set for each transformer. The pull boxes will need to be coordinated with the local power company.

Question 10. What is the size for the communications conduit(s)? On the site

Answer: (2)3"C for communications conduits to street. Pull box specs for those are on site plan.

Question 11. What is the specs for the roofing panel on the dugouts and concession?

Answer: Please see the answer to Question 6, above.

END OF ADDENDUM NO. 1



Attachments:
Site Plan, Sheet 2

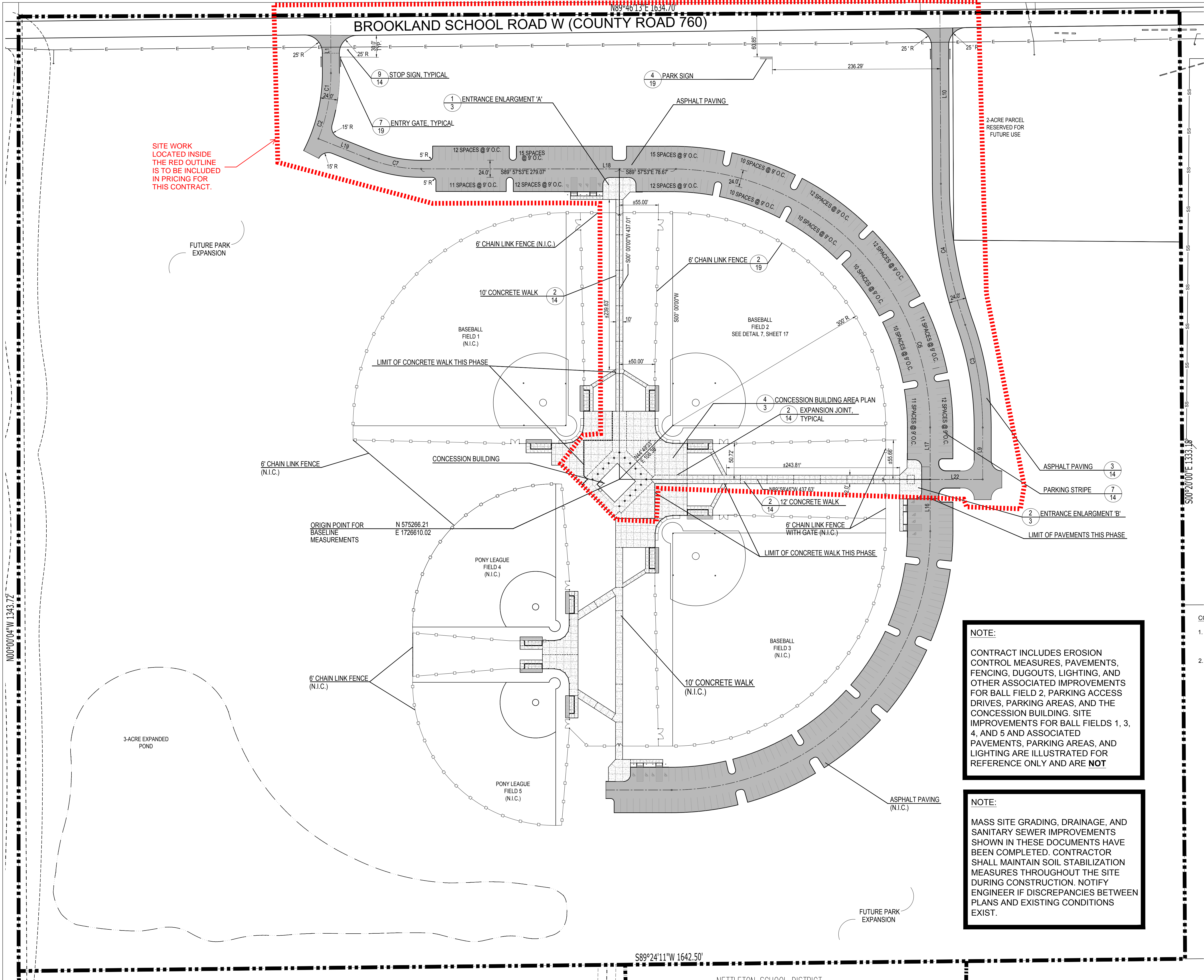

LINE TABLE		
LINE #	BEARING	DISTANCE
L1	N0° 13' 47\"W	79.26'
L9	S0° 00' 03\"W	73.08'
L10	S0° 19' 18\"E	240.54'
L16	S0° 03' 06\"E	72.86'
L17	S0° 03' 06\"E	73.41'
L18	S89° 57' 53\"E	357.74'
L19	S68° 19' 35\"E	76.46'
L22	S89° 59' 57\"E	73.93'

CURVE TABLE			
CURVE #	LENGTH	RADIUS	DELTA ANGLE
C1	57.03'	250.00'	13.06
C2	39.67'	250.00'	9.09
C3	147.40'	438.09'	19.28
C4	202.48'	612.00'	18.96
C5	572.10'	364.00'	90.05
C6	565.37'	364.09'	88.97
C7	75.53'	200.00'	21.64

NOTE:

CONTRACT INCLUDES EROSION CONTROL MEASURES, PAVEMENTS, FENCING, DUGOUTS, LIGHTING, AND OTHER ASSOCIATED IMPROVEMENTS FOR BALL FIELD 2, PARKING ACCESS DRIVES, PARKING AREAS, AND THE CONCESSION BUILDING. SITE IMPROVEMENTS FOR BALL FIELDS 1, 3, 4, AND 5 AND ASSOCIATED PAVEMENTS, PARKING AREAS, AND LIGHTING ARE ILLUSTRATED FOR REFERENCE ONLY AND ARE **NOT**

NOTE:

MASS SITE GRADING, DRAINAGE, AND SANITARY SEWER IMPROVEMENTS SHOWN IN THESE DOCUMENTS HAVE BEEN COMPLETED. CONTRACTOR SHALL MAINTAIN SOIL STABILIZATION MEASURES THROUGHOUT THE SITE DURING CONSTRUCTION. NOTIFY ENGINEER IF DISCREPANCIES BETWEEN PLANS AND EXISTING CONDITIONS EXIST.

- CONSTRUCTION LAYOUT GENERAL NOTES:
1. EROSION CONTROL MEASURES MUST BE IN PLACE PRIOR TO COMMENCEMENT OF ANY LAND DISTURBANCE ACTIVITIES. SEE CIVIL DETAILS ON SHEET 14, DETAIL 1.
 2. CONTRACTOR SHALL REFERENCE THIS PLAN FOR LOCATION OF CONTROL AND EXPANSION JOINTS IN CONCRETE PAVEMENT. SEE DETAIL 2, SHEET 14.

